



3 Vicarage Crescent, Tittensor

£335,000 Freehold



Situated in the picturesque village of Tittensor, this three-bedroom detached bungalow enjoys the quaint charm of a close-knit community. • This home has been extended and cared for, making it a move-in ready haven, and being offered for sale with no upward chain. • The modern kitchen diner to the cosy living room, this bungalow offers versatile living spaces. The fabulous conservatory, which opens to the patio, and the separate dining room provide ample space. • The wrap-around garden is a true gem, offering multiple spots to sit and enjoy either sunshine or shade. Tucked away at the end of a cul-de-sac, with driveway parking and single garage. • Located on Vicarage Crescent, having excellent commuter links, outstanding schools, and local amenities within easy reach, it combines convenience with the beauty of nature.



In the charming village of Tittensor, you will find this delightful three-bedroom detached bungalow on Vicarage Crescent. With St. Luke's Church just across the way, offering views of the steeple, the church bells won't be the only thing ringing; our phone will be off the hook with interest for this bungalow. Upon entering, you'll be greeted by a spacious entrance hall with handy storage cupboards to ensure everything has its place. The modern kitchen diner, equipped with a gas hob and double oven, integrated dishwasher and washing machine, with ample unit space, and an abundance of natural light. The living room features a bow window to the front and an electric fire for those cooler evenings. French doors open into a fabulous conservatory, a versatile space ideal for relaxation, leading seamlessly to the inviting patio area. A separate dining room offers plenty of living space. As we move towards the rear of the bungalow, three double bedrooms await. The main bedroom boasts an ensuite with a walk-in shower and fitted wardrobes. The second bedroom also features fitted wardrobes, while the third bedroom, previously used as a study, offers flexibility for various uses. The main bathroom is elegantly designed with a generous walk-in shower. Outside, this bungalow is tucked away at the end of a cul-de-sac, offering a real sense of privacy. The immaculate wrap-around garden provides numerous spots to sit and relax, whether in the sunshine or shade, and is mainly laid to lawn with a charming patio area. The driveway offers off-road parking and leads to a single garage, adding to the convenience of this delightful home. Vicarage Crescent in Tittensor is renowned for its picturesque surroundings, with the esteemed 'Green Drive' offering stunning lake and woodland trails nearby. Excellent commuter links, outstanding schools, and local amenities are all within easy reach. This bungalow is being sold with no forward chain. Don't miss the opportunity to make this your new home. Ding dong, you will be ringing our bell to organize a viewing and experience the charm that Vicarage Crescent has to offer.



Charming 3-bed detached bungalow in Tittensor with views of St. Luke's Church. Modern kitchen, spacious living areas, conservatory, wrap-around garden, off-road parking, and garage. No forward chain. Ideal for serene village living. Call now to view!

Council Tax band: C

Tenure: Freehold

EPC Energy Efficiency Rating: D

EPC Environmental Impact Rating: D



GROUND FLOOR 1304.31 sq. ft.
(121.17 sq. m.)

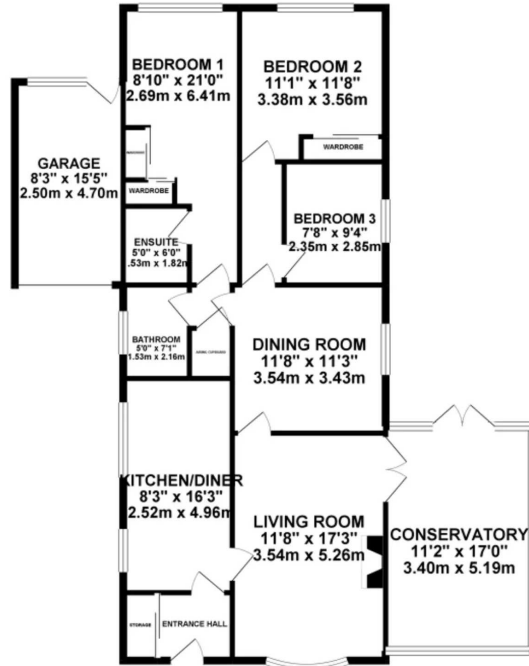

TOTAL FLOOR AREA : 1304.31 sq. ft. (121.17 sq. m.) approx.

While every effort has been made to ensure the accuracy of the figures contained here, measurements of floor, wall, ceiling and any other parts are approximate and the responsibility is taken for any error or omission of the diagrams. This plan is for guidance purposes only and should be used as such by any prospective purchaser. The services, systems and appliances shown have not been tested and no guarantee as to their operability or efficiency can be given.
Made with Midplan - 8/2014

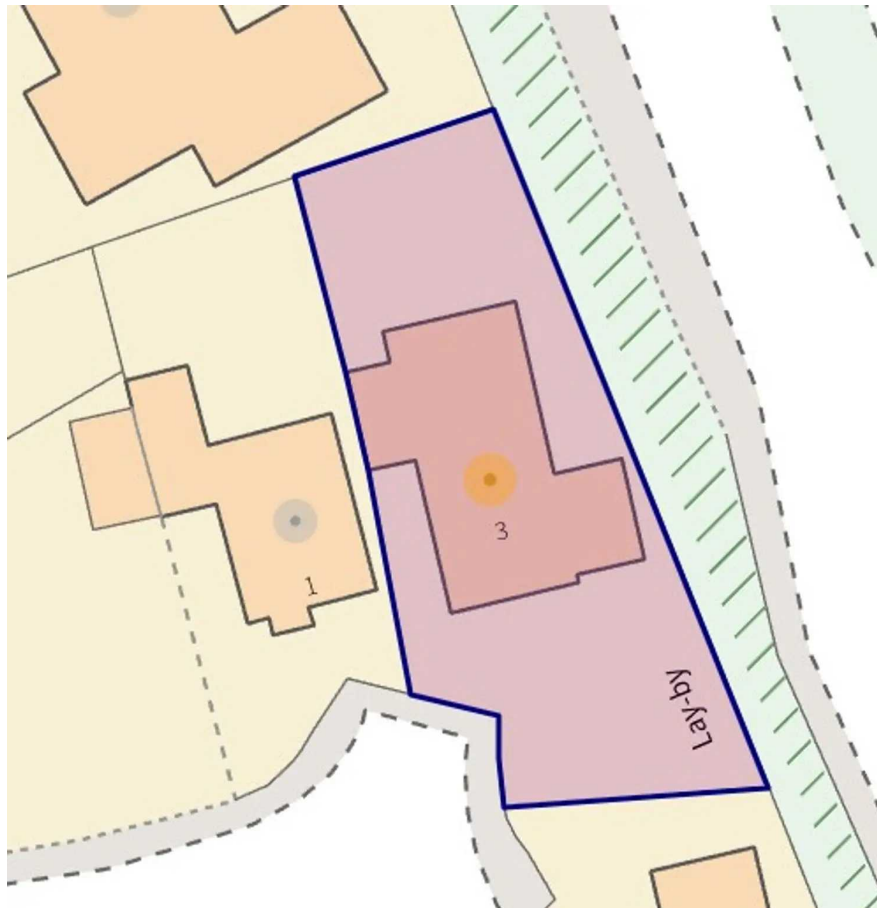

You can include any text here. The text can be modified upon generating your brochure.

01785 814917