



1 New Row, Madeley Heath

£130,000 Freehold



A charming two bedroom terraced property, perfect for first time buyers or investors • With generous living accommodation to the ground floor including a kitchen, living room with a door into the garden and the bathroom • To the first floor there are two large double rooms with bedroom two benefitting from an over stairs storage cupboard. • To the front there is an enclosed courtyard and to the rear is a mature lawned garden. • Situated in Madeley, the perfect location for those needing to commute.



Whether you're a first-time buyer ready to spread your wings or an investor seeking an addition to your portfolio, this place has something special to offer and is a true blank canvas for you to really make your own. As you walk through the front door, you're greeted by an inviting entrance hall with a door to the right hand side into the bathroom, stairs to the first floor landing. The kitchen is bright and airy, with plenty of space to whip up delicious meals and brew your morning coffee. Make your way through to the living room where you can find an exposed brick feature chimney and a door leading out into the rear garden. Before we head upstairs, let's have a look in the bathroom - Imagine soaking in a warm bubble bath after a hectic day, letting all your worries melt away. It's a space where you can unwind and pamper yourself. Now, let's head upstairs to the first floor, where two spacious double bedrooms await. Bedroom two boasts an over stairs storage cupboard, perfect for stashing away all your belongings and keeping the room clutter-free. The bedrooms are cosy and comfortable, offering a peaceful retreat at the end of the day. Outside, to the front, you'll find an enclosed courtyard - a private outdoor space where you can enjoy your morning cup of coffee or watch the world go by. To the rear, there's a mature lawn garden, a tranquil oasis where you can escape the hustle and bustle of every-day life and connect with nature. Located in the heart of Madeley, this property is perfect for those needing to commute. With easy access to transport links and amenities, you'll have everything you need right at your doorstep. Whether you're popping out for groceries or heading off to work, everything is just a stone's throw away. In summary, this charming terraced property offers a cosy retreat from the hustle and bustle of every-day life. With its generous living accommodation, peaceful bedrooms, and tranquil outdoor spaces, it's the perfect place to put down roots and create lasting memories. So, what are you waiting for? Come take a tour and discover your new home sweet home!



Council Tax band: A

Tenure: Freehold

EPC Energy Efficiency Rating: D

EPC Environmental Impact Rating:



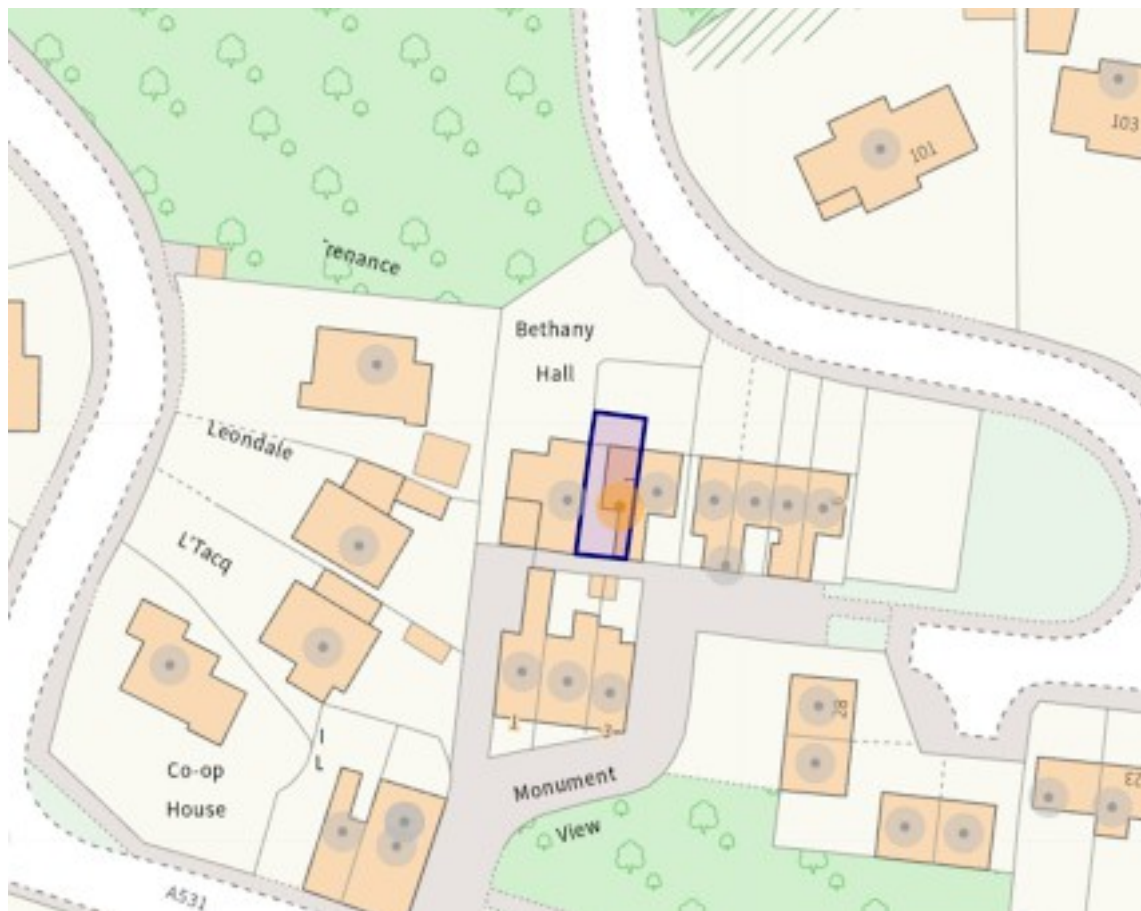

GROUND FLOOR 356.71 sq. ft.
(33.14 sq. m.)

1ST FLOOR 278.18 sq. ft.
(25.84 sq. m.)

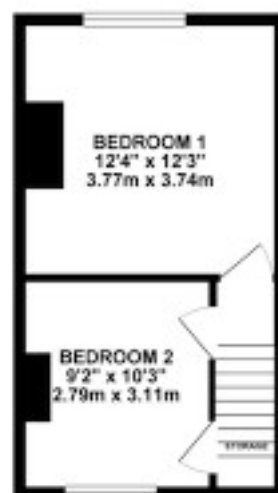

TOTAL FLOOR AREA: 634.89 sq. ft. (58.98 sq. m.) approx.
 This floor plan is intended to provide a general impression of the proposed development. It is not intended to be used as a contract document. The ground floor and first floor plans are shown for information only. The ground floor and first floor plans are shown for information only. The ground floor and first floor plans are shown for information only. The ground floor and first floor plans are shown for information only.