



32 Lichfield Street, Stone

£295,000 Freehold



Victorian family home with three double bedrooms and a further spacious single, serviced by the family bathroom with a bath, shower, wash-hand basin and W/C. • Perfectly situated just a short walk to Stone's vibrant centre, you are nearby excellent schools, shops, bars and restaurants. Commuters will appreciate easy transport links via road and rail. • Two reception rooms, spacious kitchen/diner providing space for all your appliances, there is also a large cellar. • Ideal for growing families or an investor looking for another addition to their portfolio. This home is also being offered for sale with NO CHAIN!!! • Spacious courtyard garden with outbuildings, open garden to the rear.



While Stone boasts many Victorian properties, this one is truly unique—much like the stars in the sky, no two are the same. This beautiful four-bedroom terraced home offers a wonderful opportunity to embrace its original charm while infusing your own personal style. As you step inside, a handy porch area greets you, perfect for kicking off your shoes before entering the home. From here, the welcoming entrance hall leads you to the first of two reception rooms. Both reception rooms are bathed in natural light, thanks to the large windows, and boasts beautiful fireplaces and feature alcoves. The kitchen/diner to the rear of the home is beautifully appointed, with ample space for all your appliances, making it the perfect setting for cooking your famous Sunday roast. The property benefits from a downstairs W/C and access to the large cellar. Upstairs, you'll find three double bedrooms and a further generously sized single bedroom. The family bathroom is spacious, offering a bath and shower, wash-hand basin and W/C. Outside, the property has a generously sized courtyard garden, with useful outbuildings providing extra storage and another W/C that could possibly be renovated into another living area (STNPP). Beyond the rear courtyard, you'll find an open garden with a lush grass lawn—ideal for enjoying the sunshine. Perfectly located just a short walk from Stone's bustling town centre, this home is close to a range of excellent schools, shops, bars and restaurants. For commuters, the easy transport links via both road and rail make this an ideal spot. You also have Stone train station just a short walk away. Transform this Victorian gem into your very own masterpiece. So, if you're ready to roll up your sleeves and add your own twist, this house is ready to be your canvas.



Victorian 4-bed terraced home in Stone. Two reception rooms, spacious kitchen/diner, cellar, courtyard garden. Close to schools, shops, transport links. Ideal for adding your personal touch.

Council Tax band: B

Tenure: Freehold

EPC Energy Efficiency Rating: E

EPC Environmental Impact Rating: E



GROUND FLOOR 566.76 sq. ft.
(52.65 sq. m.)



1ST FLOOR 623.81 sq. ft.
(57.95 sq. m.)

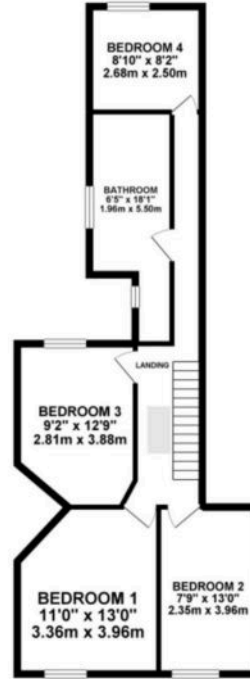

TOTAL FLOOR AREA: 1190.57 sq. ft. (110.61 sq. m.) approx.
Whilst every attempt has been made to ensure the accuracy of the floorplan contained here, measurements of plots, individual rooms and any other items are approximate and to be regarded as a guide for any other dimensions or specifications. The plan is for illustrative purposes only and should be used as such by any prospective purchaser. The names, systems and quantities shown here are not intended to be a guarantee, as to their availability or otherwise, and to be given.
Made with Cadpan 8.0.0.0



You can include any text here. The text can be modified upon generating your brochure.