



16 Newlands Close, Stone

£285,000 Freehold



Immaculately presented with neutral décor, this two-bedroom bungalow provides a perfect blank canvas for your next chapter. • Recently fitted and designed for everyday ease, the modern kitchen boasts two windows, allowing natural light to pour in and making mornings feel bright and fresh. • The generous lounge offers plenty of space to relax, with room to introduce a dining area, creating the ideal lounge/diner to suit your needs. • Step outside to a beautifully maintained garden, complete with a seating area, patio, and lawn, all set against stunning views over Stone, a perfect spot to unwind in the fresh air. • The carport has been cleverly transformed into a sheltered seating area, capturing the south-facing sunshine, while ample driveway parking and a good-sized garage add extra practicality.



A fresh start blooms on Newlands Close! Spring is in the air, and what better time to embrace **new beginnings** than with this **immaculate two-bedroom bungalow**? Tucked away at the end of a **quiet cul-de-sac** on the outskirts of **Stone**, this beautifully kept home is fresh, bright, and ready for you to move straight in....just in time for a season of change! Step inside to a **recently fitted modern breakfast kitchen**, where **sunlight streams in through two windows**, making it a fresh and inviting space. With plenty of room for all your appliances, it's the perfect place to start your mornings. Flowing through, the **spacious living room** offers versatility, it's currently set up as a cosy lounge, but there's **ample space to create a lounge/diner**, bringing a touch of sociable living into your home. Two **double bedrooms**, both with fitted wardrobes, provide restful retreats, with one offering **direct access to the garden**, wake up to the sights and sounds of nature right on your doorstep! A **modern walk-in shower room** completes the home, ensuring comfort and convenience. Outside, **the carport is more than just a place for parking**, cleverly designed as an outdoor seating area, it captures **the south-facing sunshine** from the front, making it a lovely spot to **sit back and soak in the first warmth of spring**. With **plenty of driveway space**, you could keep the carport purely as a sheltered spot to relax! A **good-sized garage** provides additional storage or a handy workspace for those who like to potter. To the rear, the **landscaped garden** is a true delight, featuring a **seating area, patio, and lawn**, all set against **beautiful views over Stone**...a picturesque place to enjoy the **new season in full bloom**. With **local shops** and a **bus service into town** close by, this home offers the best of **peaceful living with everyday convenience**. **Spring into action and make this fresh start yours!**



Spring into a fresh start on Newlands Close! This immaculate two-bedroom bungalow offers stunning views, and a peaceful cul-de-sac setting, ready for you to turn the page to a new chapter. Council Tax band: C

Tenure: Freehold

EPC Energy Efficiency Rating: D

EPC Environmental Impact Rating: D



GROUND FLOOR 862.06 sq. ft.
(80.09 sq. m.)

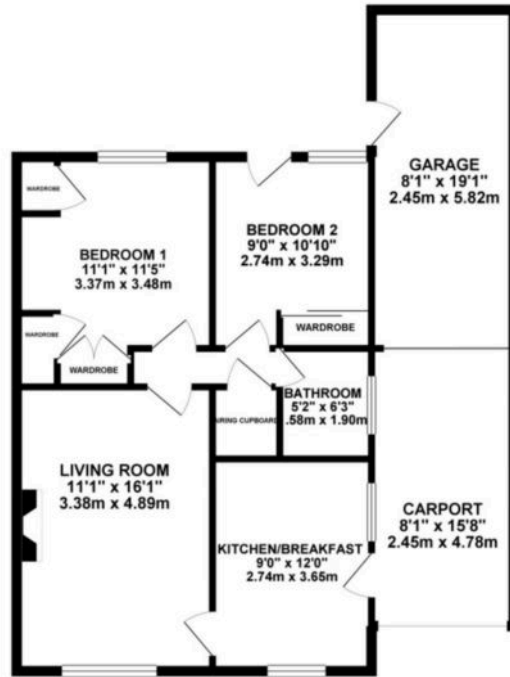

TOTAL FLOOR AREA: 862.06 sq. ft. (80.09 sq. m.) approx.
Whilst every attempt has been made to ensure the accuracy of the floorplan contained here, measurements of walls, windows, doors and any other items are approximate and no responsibility is taken for any errors or omissions in this document. This plan is for illustrative purposes only and should be used as such for any prospective purchase. The services, systems and appliances shown here are not intended to be used as such for any prospective purchase. All dimensions are approximate and should be used as a guide.
Made with ArchiCAD 2022

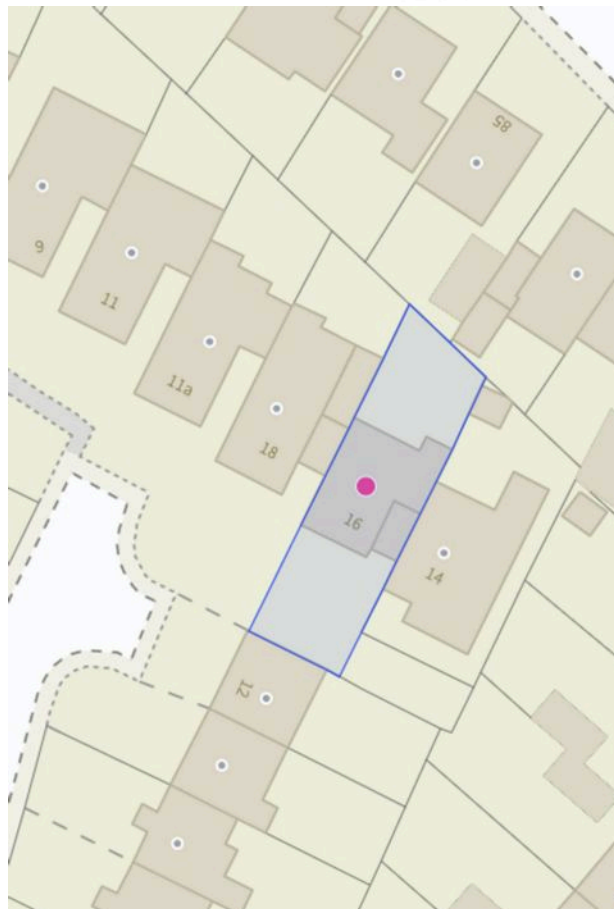

You can include any text here. The text can be modified upon generating your brochure.